

Mako G

G-507



- Ultra-compact (60.5 × 29 × 29 mm)
- Affordable
- PoE
- Sony IMX264 CMOS sensor

Description

GigE Vision camera with Sony IMX264 sensor, global shutter

Mako G-507B/G-507C is an industrial GigE camera with the Sony IMX264 CMOS sensor. Mako G cameras have the same compact form factor and the same mounting positions as many analog cameras. All models include Power over Ethernet (PoE), three opto-isolated outputs, and a 64 MB image buffer. The image quality profits from the precisely aligned sensors.

Options:

- Various optical filters and lens mounts
- White medical housing

See the [Modular Concept](#) for lens mount, optical filter, and case design options.

Specifications

Mako G	G-507
Interface	IEEE 802.3 1000BASE-T, IEEE 802.3af (PoE)
Resolution	2464 (H) × 2056 (V)
Sensor	Sony IMX264
Sensor type	CMOS
Cell size	3.45 μm x 3.45 μm
Lens mount	C-Mount
Max frame rate at full resolution	23.7 fps
ADC	12 bit
Image buffer (RAM)	64 MByte
Output	

Mako G	G-507
Bit depth	12 bit
Mono modes	Mono8, Mono12, Mono12Packed
General purpose inputs/outputs (GPIOs)	
Opto-isolated I/Os	1 input, 3 outputs
Operating conditions/dimensions	
Operating temperature	+5 °C to +45 °C housing temperature
Power requirements (DC)	12 to 24 VDC; PoE
Power consumption (@12 V)	2.4 W @ 12 VDC; 2.8 W PoE
Mass	80 g
Body dimensions (L × W × H in mm)	60.5 × 29 × 29 (including connectors)
Regulations	CE, RoHS, REACH, WEEE, FCC, ICES

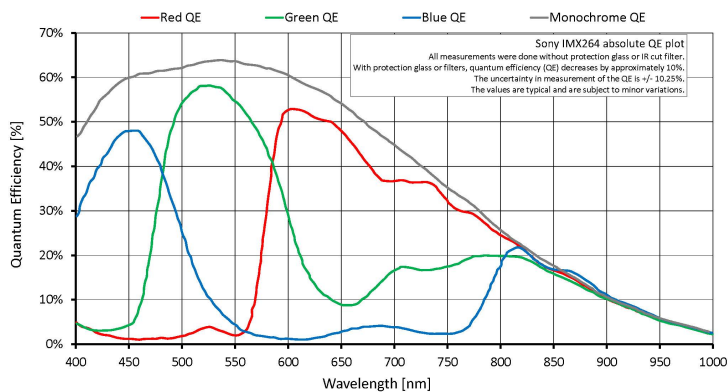

Features

#Image optimization features:

- Auto gain (manual gain control: 0 to 40 dB)
- Auto exposure (52##s to 85.9 s; 19.5##s increments)
- Auto white balance
- Binning
- Color correction, hue, saturation (color models only)
- Decimation
- Gamma correction



- Look-up tables (LUTs)
- Column defect masking
- Region of interest (ROI), separate ROI for auto features

Camera control features:

- Event channel
- Image chunk data
- Storable user sets
- StreamBytesPerSecond (easy bandwidth control)
- StreamHold
- Sync out modes: Trigger ready, input, exposing, readout, imaging, strobe, GPO
- Temperature monitoring

Technical drawing

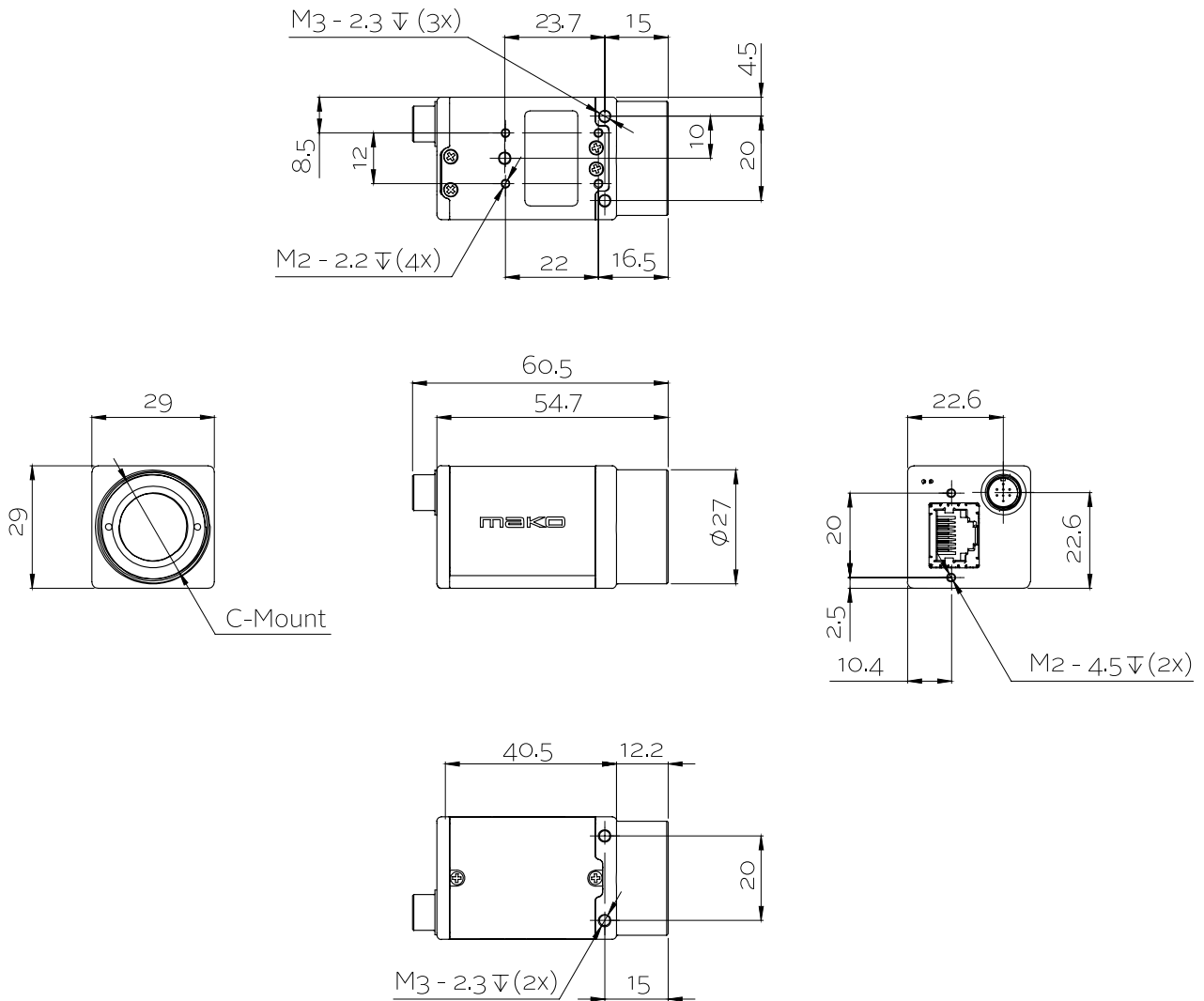

Applications

Mako G-507B/G-507C is suitable for all typical machine vision applications including:



- Robotics
- Quality control
- Inspection, surveillance
- Industrial imaging
- Machine vision
- Logistics