

L series | IP dome camera

LD2122

1080P HD Dome IP Camera

www.meritlilin.com



- ▶ Stylish dome IP camera
- ▶ Full HD 2 megapixel CMOS image sensor
- ▶ Motion detection
- ▶ Screw-on design dome cover for easy and secure installation

Dimensions: (unit: mm)
 Ø 120 x 102

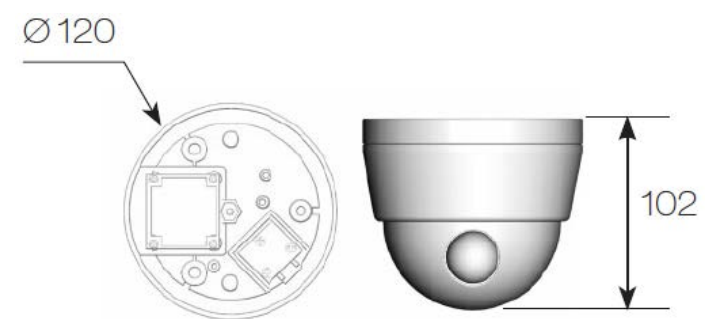
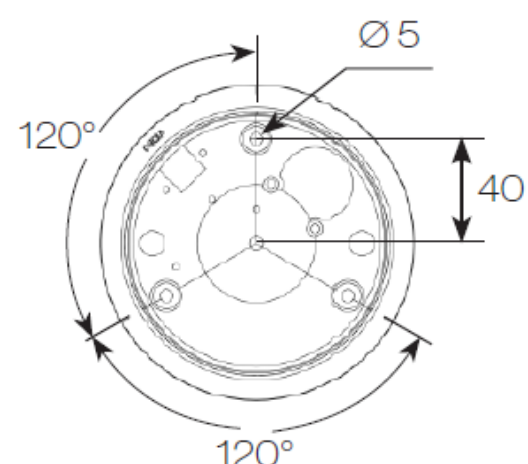

Diagram of mounting holes: unit in mm



Fixed dome LD2122 in the L series is featuring built-in Sense up+ technology to deliver stunning video in low-light conditions. Utilizing intelligent image signal processing, 2D WDR function, AGC control, and 3D Noise Reduction, the combination successfully delivers the ultimate low-light image without motion blur. Support with PoE, privacy mask, White balance, and minimum illumination 0.6 Lux at F1.6 Low Light Mode or 0.8 Lux at F1.8 Low Light Mode.

Video Security App

Available on Android and iOS – **LILINViewer** app provides security alarm push notification, real-time live viewing, and remote video playback



Privacy Masking

Privacy Masking is a feature used to protect personal privacy by concealing private areas in the camera's field of view. Doorways and house windows for example are not subject to surveillance



Back Light Compensation

Back Light Compensation (BLC) adjusts the exposure of the entire image to properly expose the subject in the foreground. No matter if the main object is moving toward left, right, upper, lower, or any location in the screen, BLC provides perfect exposure for an object in front of strong back light

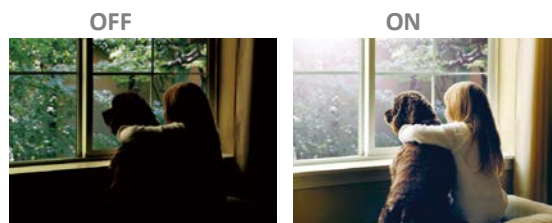

3D Noise Reduction

Remove noise from a signal. Suppressing noise in an image in low light conditions and able to retain quality videos at the same time



ONVIF-compliant

Open Network Video Interface Forum (ONVIF) is a standard for physical IP based security products. LR2122 camera is ONVIF Profile S conformant



Sense Up+

Deliver outstanding video outputs in poor light conditions without experiencing motion blur. You can see video clearly even during nighttime without sufficient lighting support



Motion Detection

Detect motion and capture the event. Motion in the selected area will provoke an alert.



Wide Dynamic Range (WDR)

Wide Dynamic Range (WDR) displays details of both the brightest and darkest areas. WDR can extend image visibility under high contrast lighting scenes and improve image quality



1080P HD Dome IP Camera

Video performance

| | | |
|-------------------------|--------------------|-----------------|
| Model# | LD2122E4 | LD2122E6 |
| Low Light Mode (Colour) | 0.6 Lux at F1.6 | 0.8 Lux at F1.8 |
| 2D WDR | Off / x2 / x3 / x4 | |

Power

| | | |
|-------------------|--|--|
| Power consumption | DC12V, 5W / PoE, 6W | |
| PoE | IEEE 802.3af | |
| Power supply | DC12V ±10% | |
| | Power over Ethernet (IEEE 802.3af compliant) | |

Sensor

| | | |
|---------------------|--|--|
| Sensor type | 1/2.7" CMOS image sensor | |
| Total sensor pixels | 1920 (H) x 1080 (V) = 2,073,600 pixels | |

Lens

| | | | |
|---------------|----------|----------|-------|
| Model# | LD2122E4 | LD2122E6 | |
| Focal length | 4mm | 6mm | |
| Iris | F1.6 | F1.8 | |
| Angle of View | H | 84.8° | 57.6° |
| | V | 45.2° | 31.4° |
| | D | 100.6° | 67.3° |

Environmental

| | |
|-----------------------|-------------------------------|
| Operating temperature | -25°C ~ +50°C (-13°F ~ 122°F) |
|-----------------------|-------------------------------|

PC requirement

| | |
|-----|---|
| CPU | Intel Pentium 4 1.8GHz or above |
| OS | Windows 2000, Windows XP, Windows Vista, Windows 7, Windows 8 |
| RAM | 1GB or above, Independent Display Card |

Mechanical

| | |
|------------|---------------|
| Dimensions | Ø 120 x 102mm |
| Weight | 400g approx. |

Certifications

| | |
|-----|--|
| CE | Emission EN 55022:2010 Class A IEC 61000-3-2:2005+A1:+A2:2009 IEC 61000-3-3:2008 |
| FCC | Emission FCC Part 15: Subpart B (10-1-10 Edition) Class A CISPR 22: 2008 Class A |

Video streaming

| | |
|---------------------|---|
| Video compression | H.264 , Motion JPEG |
| Streaming | RTP/HTTP, RTP/TCP, RTP/UDP, Multicast Multiple configurable streams in H.264 and M-JPEG, configurable frame rate and bandwidth |
| Bitrate | 128Kbps ~ 5Mbps Frame rate and bitrate controllable on-the-fly VBR / CBR / GOP supported |
| IP filter | Yes |
| RTSP Authentication | On / Off |

Video resolution (H x V)

| | |
|--------------------|---|
| 1080p HD | 1920 x 1080 |
| 720p HD | 1280 x 720 |
| D1 | 720 x 480 |
| CIF | 352 x 240 |
| Maximum frame rate | H.264 : up to 15 fps @ 1920 x 1080 , 30fps @ 1280 x 720 , 30fps @ 720 x 480 Motion JPEG : up to 15 fps @ 1920 x 1080 , 30 fps @ 720 x 480 , 30 fps @ 352 x 240 |

Video functions

| | |
|----------------------------|--|
| Scanning system | Progressive scan |
| Chip size | 5.856mm (H) x 3.276mm (V) |
| Adjustable picture setting | Contrast, Brightness, Saturation |
| White balance | Auto / Tungsten / Indoor / Fluorescents1 / Fluorescents2 / Outdoor1 / Outdoor2 |
| Shutter | 1/30(1/25)s to 1/8000s |
| Back light compensation | On / Off |
| 3D noise reduction | Off / 1 to 32 selectable |
| Privacy masking | Four independent areas |
| Sense Up | Off / 1 frame / 2 frames / 3 frames / 7 frames |
| Sense Up+ | Yes |
| Auto gain control | 36 dB variable gain |
| Other functions | Sharpness, Image flip, Image mirror, Hue |
| D/N quality setting | Yes |

Integration

| | |
|---------------------|---|
| Mobile application | Integrated to LILIN mobile app (LILINViewer) iPhone, iPad, Android support |
| Video management | ONVIF Profile S LILIN NAV 1.0 Third party VMS through LILIN HTTP API |
| Web browser | Microsoft® Internet Explorer® 6.0 and later |
| Firmware | Firmware upgrade via HTTP |
| Alarm functions | Image upload over FTP and E-mail by motion detection |
| Alarm event | FTP,SMTP, HTTP post, SD card, SAMBA |
| Alarm weighted mode | Yes |

Network

| | |
|------------------|--|
| Ethernet | 10Mbps / 100Mbps Base-T, RJ-45 |
| Connectivity | ONVIF Profile S |
| Users | 8 simultaneous users |
| Digital zoom | Yes |
| OSD | Text overlay for date, time and camera name |
| CPU, Memory | Embedded SoC ARM11, 528MHz, 256MB DDR2, 256MB flash memory |
| Video display | LILIN Universal ActiveX & LILIN Java Applet |
| OS | Embedded Linux 2.6.32 |
| Protocols | IP, TCP, UDP, HTTP, SMTP, NTP, DDNS, UPnP, FTP, ARP, DHCP, PPPoE, DNS, RTSP, RTCP, Telnet, ICMP, IGMP, ONVIF Profile S, SNMP, SIP, Bonjour |
| Multi IP address | Yes |

Network security

| | |
|---------------|--|
| User accounts | 10 user accounts available |
| Access | Multiple user access levels with password protection |
| Encryption | Base 64 HTTP encryption |