

L series | IP bullet camera

LR7722X

D/N Outdoor 35M IR Range Vari-focal IP Camera

www.meritlilin.com



2-way audio



IP66



SD card recording



Day/Night



Infrared



IP based



- ▶ Outdoor Bullet Camera
- ▶ IR cut filter for day/night operations
- ▶ IP66 rain and dust resistant
- ▶ 35-metre infrared night vision
- ▶ 1080p resolution

Dimensions: (unit: mm)

Body : 98.5(W) x 90(H) x 195(D) Bracket : 160mm(L)

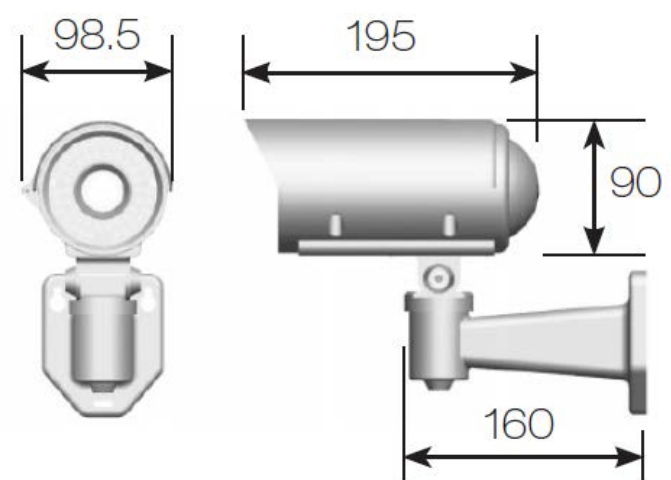
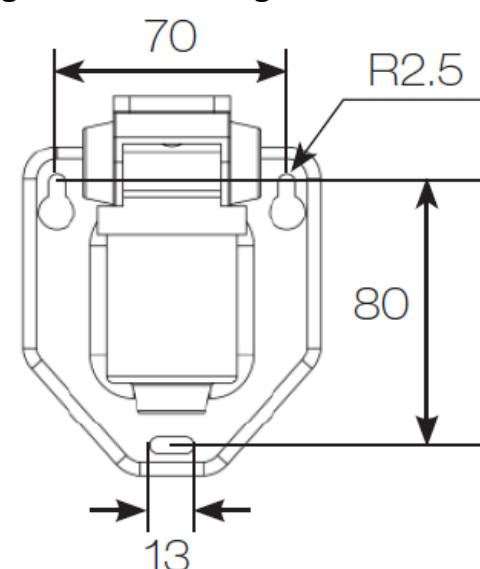

Diagram of mounting holes: unit in mm



The L series cameras are your economical choice for small and medium sized businesses. LR7722X in the L series is featuring built-in Sense up+ technology to deliver stunning video in low-light conditions. Utilizing intelligent image signal processing, 2D WDR function, AGC control, and 3D Noise Reduction, the combination successfully delivers the ultimate low-light image without motion blur. The IP66-rated housing is designed to help the camera body withstand rain and dust and ensures operation under a multitude of harsh weather conditions. Support with PoE, privacy mask, White balance, and minimum illumination 0.1 Lux at F1.4 Low Light Mode.

Built-in IR Illumination

LR7722X IP camera with infrared (IR) illumination where IR LEDs are built-in. Built-in with IR LED, the camera provides night vision up to 35 metres

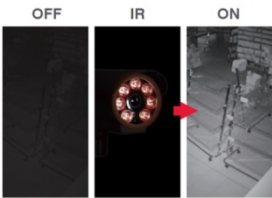

Video Security App

Available on Android and iOS – **LILINViewer** app provides security alarm push notification, real-time live viewing, and remote video playback



SD Cards in Sync with NAV Software

LR7722X camera with built-in Micro SD/SDHC card slots can provide redundant video viewing and recording. You can synchronize an SD card with LILIN VMS (Video Management Software) – Navigator (NAV)



Wind and Rain Standards

Meet international IP66 standards for dust and moisture resistant allowing you to install cameras in environments subject to wind and rain



3D Noise Reduction

Remove noise from a signal. Suppressing noise in an image in low light conditions and able to retain quality videos at the same time



Alarm Detection

Alarm Detection is designed to provide the electronic detection of intruders



Motion Detection

Detect motion and capture the event. Motion in the selected area will provoke an alert.



ONVIF-compliant

Open Network Video Interface Forum (ONVIF) is a standard for physical IP based security products. LR7722X camera is ONVIF Profile S conformant



Day and Night Operations via Removal of the IR-cut filter

LR7722X camera was designed using a mechanical IR cut filter for increased IR sensitivity resulting in improved night time images. The removable IR-cut filter allows day and night operations even in the low lux condition providing outstanding vision



Sense Up+

Deliver outstanding video outputs in poor light conditions without experiencing motion blur. You can see video clearly even during nighttime without sufficient lighting support



Two-way Audio Support

With 2-way audio communication, you can project your voice through the camera's speaker instead of hearing what's going on



Wide Dynamic Range (WDR)

Wide Dynamic Range (WDR) displays details of both the brightest and darkest areas. WDR can extend image visibility under high contrast lighting scenes and improve image quality



Privacy Masking

Privacy Masking is a feature used to protect personal privacy by concealing private areas in the camera's field of view. Doorways and house windows for example are not subject to surveillance

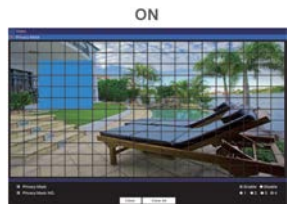

Audio Detection

With Audio Detection technology, an alarm is triggered based on ambient sound conditions as the threshold



D/N Outdoor 35M IR Range Vari-focal IP Camera

Video performance	
Model#	LR7722EX3.6
Low Light Mode (Colour)	0.1 Lux at F1.4
With Infrared	0.0 lux
2D WDR	Off / x2 / x3 / x4

Power	
Power consumption	DC12V, 10.5W / PoE, 12W
PoE	IEEE 802.3af
Power supply	DC12V ±10%
	Power over Ethernet (IEEE 802.3af compliant)

Sensor	
Sensor type	1/2.7" CMOS image sensor
Total sensor pixels	1920 (H) x 1080 (V) = 2,073,600 pixels

Certifications	
Model #	LR7722EX3.6
CE	EN 55022:2010 Class A
	IEC 61000-3-2:2005+A1:2008+A2:2009
	IEC 61000-3-3:2008
FCC	FCC Part 15: Subpart B (10-1-10 Edition) Class A CISPR 22: 2008 Class A
IP Rating / IK Rting	IP66 waterproof / IK10

Lens		
Focal length		2.8 mm ~ 12 mm
Iris		F1.4
Angle of View	H	91.2° ~ 25.5°
	V	59.4° ~ 22.4°
	D	99° ~ 37.3°

Night vision (infrared LED)	
Distance	35m
Peak wavelength	850nm, high efficiency array
Beam spread	30°

Environmental	
Operating temperature	-40℃ to 50℃ (-40°F to 122°F)

PC requirement	
CPU	Intel Pentium 4 1.8GHz or above
OS	Windows 2000, Windows XP, Windows Vista, Windows 7, Windows 8
RAM	1GB or above, Independent Display Card

Mechanical	
Dimensions (W x H x D)	Body : 98.5 x 90 x 195mm, Bracket : 160mm (L)
Weight	1450g approx.
Window	Ø72 Heat Resistant Glass

Input / output	
Audio input / output	Mono, 1.4 Vp-p , 50 KΩ , Terminal connector
Alarm input / output	Digital 1 input (TTL, +3 ~ 5VDC) / 1 Output (MOS Relay contact N.O., Load max. 40VDC/300mA)
Live video output	CVBS 1.0Vp-p, 75 ohm, BNC connector

Video streaming	
Video compression	H.264 , Motion JPEG
Streaming	RTP/HTTP, RTP/TCP, RTP/UDP, Multicast Multiple configurable streams in H.264 and M-JPEG, configurable frame rate and bandwidth
Bitrate	128Kbps ~ 5Mbps Frame rate and bitrate controllable on-the-fly VBR / CBR / GOP supported
IP filter	Yes
RTSP Authentication	On / Off

Video resolution (H x V)	
1080p HD	1920 x 1080
720p HD	1280 x 720
D1	720 x 480
CIF	352 x 240
Maximum frame rate	H.264 : up to 15 fps @ 1920 x 1080 , 30fps @ 1280 x 720 , 30fps @ 720 x 480
	Motion JPEG : up to 15 fps @ 1920 x 1080 , 30 fps @ 720 x 480 , 30 fps @ 352 x 240

Video functions	
Day/Night (IR-cut filter)	Colour (Day), Monochrome (Night), Auto, Schedule
Scanning system	Progressive scan
Chip size	5.856mm (H) x 3.276mm (V)
Adjustable picture setting	Contrast, Brightness, Saturation
White balance	Auto / Tungsten / Indoor / Fluorescents1 / Fluorescents2 / Outdoor1 / Outdoor2
Shutter	1/30(1/25)s to 1/8000s
Back light compensation	On / Off
3D noise reduction	Off / 1 to 32 selectable
Privacy masking	Four independent areas
Sense Up	Off / 1 frame / 2 frames / 3 frames / 7 frames
Sense Up+	Yes
Auto gain control	36 dB variable gain
Other functions	Sharpness, Image flip, Image mirror, Hue
D/N quality setting	Yes

Integration	
Mobile application	Integrated to LILIN mobile app (LILINViewer) iPhone, iPad, Android support
Video management	ONVIF Profile S LILIN NAV 1.0 Third party VMS through LILIN HTTP API
SD card recording	Support Micro SD/SDHC card for circular recording (card is not included)
Web browser	Microsoft® Internet Explorer® 6.0 and later
Firmware	Firmware upgrade via HTTP
Alarm functions	audio / motion / alarm detection triggering recording into SD card Image upload over FTP and E-mail by audio / motion detection
Alarm event	FTP,SMTP, HTTP post, SD card, SAMBA
Alarm weighted mode	Yes

Network	
Ethernet	10Mbps / 100Mbps Base-T, RJ-45
Connectivity	ONVIF Profile S
Users	8 simultaneous users
Digital zoom	Yes
OSD	Text overlay for date, time and camera name
CPU, Memory	Embedded SoC ARM11, 528MHz, 256MB DDR2, 256MB flash memory
Video display	LILIN Universal ActiveX & LILIN Java Applet
OS	Embedded Linux 2.6.32
2-way audio	G.711 / PCM
Protocols	IP, TCP, UDP, HTTP, SMTP, NTP, DDNS, UPnP, FTP, ARP, DHCP, PPPoE, DNS, RTSP, RTCP, Telnet, ICMP, IGMP, ONVIF Profile S, SNMP, SIP, Bonjour
Multi IP address	Yes

Network security	
User accounts	10 user accounts available
Access	Multiple user access levels with password protection
Encryption	Base 64 HTTP encryption